

Radial deep-groove ball bearings with shield

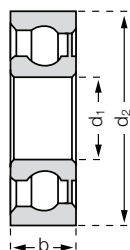

Made of xirodur® B180

PA cage, stainless steel or glass balls

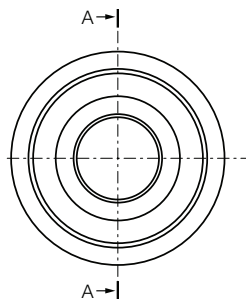

+80 °C

-40 °C

xiros® polymer ball bearings made of xirodur® B180 now with shield to prevent the penetration of dirt and other abrasive particles. The one-sided shield is fixed to the inner race. The other side is protected by the enclosed ball cage.

- Lubrication- and maintenance-free
- Dirt-repellant
- Corrosion-resistant
- Low weight
- For shaft diameter 3–20 mm
- Electrically insulating

Dimensions [mm]

Part number	Race	Cage	Ball	Inner-Ø	Outer-Ø	Width
				d1	d2	b1
BB-623-B180-10-ES-C	B180	PA	1.4401	3	10	4
BB-626-B180-10-ES-C	B180	PA	1.4401	6	19	6
BB-608-B180-10-ES-C	B180	PA	1.4401	8	22	7
BB-6000-B180-10-ES-C	B180	PA	1.4401	10	26	8
BB-6001-B180-10-ES-C	B180	PA	1.4401	12	28	8
BB-6003-B180-10-ES-C	B180	PA	1.4401	17	35	10
BB-6004-B180-10-ES-C	B180	PA	1.4401	20	42	12
BB-623-B180-10-GL-C	B180	PA	Glass	3	10	4
BB-626-B180-10-GL-C	B180	PA	Glass	6	19	6
BB-608-B180-10-GL-C	B180	PA	Glass	8	22	7
BB-6000-B180-10-GL-C	B180	PA	Glass	10	26	8
BB-6001-B180-10-GL-C	B180	PA	Glass	12	28	8
BB-6003-B180-10-GL-C	B180	PA	Glass	17	35	10
BB-6004-B180-10-GL-C	B180	PA	Glass	20	42	12

Technical Data

Part number	Max. static bearing load	Static bearing load	Dynamic bearing load	Max. speed	Weight
	axial [N]	[N]	[N]	[rpm]	[g]
BB-623-B180-10-ES-C	30	25	35	4,500	0.4
BB-626-B180-10-ES-C	95	50	70	2,600	2.5
BB-608-B180-10-ES-C	165	60	84	2,200	4.0
BB-6000-B180-10-ES-C	285	85	119	1,900	6.3
BB-6001-B180-10-ES-C	315	105	147	1,750	7.1
BB-6003-B180-10-ES-C	360	180	250	1,400	11.5
BB-6004-B180-10-ES-C	400	210	294	1,150	19.7
BB-623-B180-10-GL-C	30	25	35	4,500	0.4
BB-626-B180-10-GL-C	95	50	70	2,600	1.8
BB-608-B180-10-GL-C	165	60	84	2,200	2.7
BB-6000-B180-10-GL-C	285	85	119	1,900	4.1
BB-6001-B180-10-GL-C	315	105	147	1,750	4.7
BB-6003-B180-10-GL-C	360	180	250	1,400	8.4
BB-6004-B180-10-GL-C	400	210	294	1,150	14.2