

No. 6370ZSA-02

Pneumatic sensor unit, Control and sensor module

Operating pressure 4-7 bar.

Order no.	A	B	dia. B1	C	E	H	H1	K	L	M	N	P	dia. Q	S	Weight [g]
553182	95	20,5	5,5	75	68,5	83	78,5	18	115,5	M12 x 1	10,2	17,4	6	50	510

Design:

Pneumatic sensor unit with a control module, preassembled sensor module with integrated LCD display for displaying the operating status and two connecting cables each 5 meters in length and one open end.

Technical data per sensor module:

Distance measuring range: 0.02 - 0.2 mm

Pneumatic connection: Q6 Plug connection 6 mm

Electrical output: 2 switch outputs PNP

Electrical connection: M12 plug, A-coded

Application:

Pneumatic sensor unit for querying and condition monitoring of the AMF zero-point clamping system for the automation. The switchpoints of the sensor modules are applied directly in the teach-in process and can then be finely adjusted and adapted manually to the individual requirements.

Note:

A maximum of four sensor modules can be mounted and connected per control module.

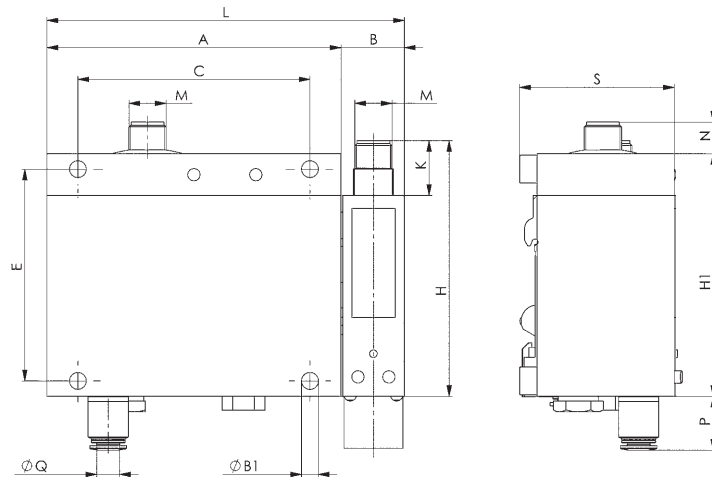

CAD



Subject to technical alterations.