

Floor Standing Enclosures

Steel Range

Accessories

Transversal sliding profiles, MTS

Description: To be used when installing a wide mounting plate. Adjustable in depth in steps of 25 mm.

Material: 3 mm zinc plated steel.

Pack quantity: 2 profiles with mounting accessories.

For enclosure	
W	Item no.
500	MTS500
600	MTS600
800	MTS800
1000	MTS1000
1200	MTS1200
1600	MTS1600

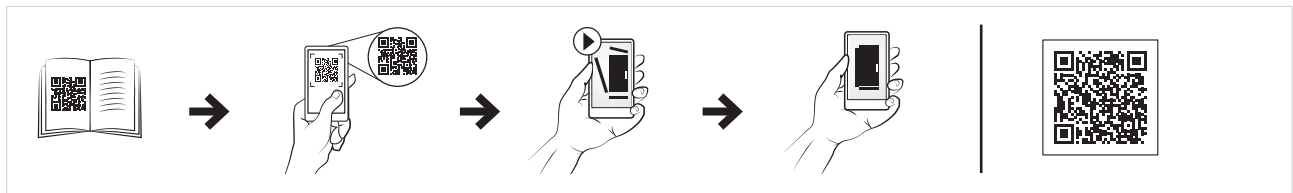

Mounting plate fixing bracket, MPE

Description: For extra support of the mounting plate in the middle, in addition to the normal top and bottom fixing.

Material: 3 mm zinc plated steel.

Pack quantity: 10 pieces.

Mounting requirement: Add CMB profiles.

Item no.
MPE10

