

# Floor Standing Steel Range Accessories

## Door stop, DSTP

**Description:** To lock an open door in position. Mounted directly to the door frame and on the enclosure profile. Allows the enclosure door to be opened up to 110 degrees.

**Material:** Zinc plated steel.

**Pack quantity:** 1 piece with mounting accessories.

<b>Item no.</b>
DSTP02

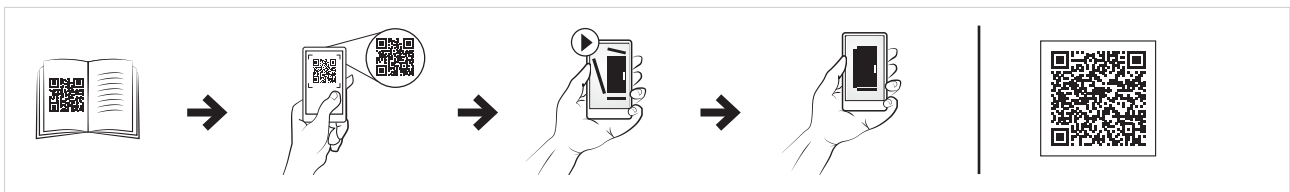

## Door wheel, DW

**Description:** For easier closing and positioning of a heavily equipped door (cooling units, etc). Mounted directly to the door frame on the bottom of the door. Highly recommended when fitting loads from 30 kg on the enclosure door.

**Material:** Zinc plated steel.

**Pack quantity:** 2 pieces with mounting accessories.

<b>Item no.</b>
DW01



## Door Plastic Support, DPSSL

**Description:** Helps to centre the door in case of an uneven floor, as well as allowing easier closing and positioning when a heavy load is mounted (cooling units, etc). Mounted directly to the door frame on the bottom and top of the door. Highly recommended when fitting loads from 30 kg on door.

**Pack quantity:** 2 plastic supports with mounting accessories.

<b>Item no.</b>
DPSSL01

