

SUPPORT, ADJUSTABLE STEPPED BLOCK DIN 6318



Material:

Heat-treated steel, painted

Note:

Centring hole diameter 12 mm. Spindle with self-locking trapezoidal thread and end lock.

2140.20.

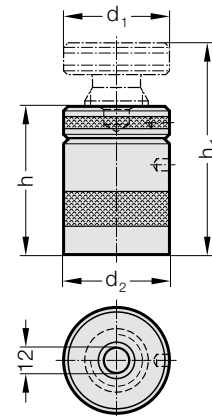

2140.20. Support, adjustable

Order No	h	h ₁	d ₁	d ₂	F _{max} [daN]
2140.20.042	42	52	50	50	6,000
2140.20.050	50	70	50	50	6,000
2140.20.070	70	100	50	50	6,000
2140.20.100	100	140	65	70	10,000
2140.20.140	140	210	70	80	17,000
2140.20.190	190	300	80	100	35,000



Material:

Engineering cast iron, painted.

Note:

Holding and contact surfaces are plane-parallel. High clamping forces can be achieved by using high-strength screws conforming to DIN 787. The dimensions of the holding strap should be matched to the strength of the bolts.

2140.19.

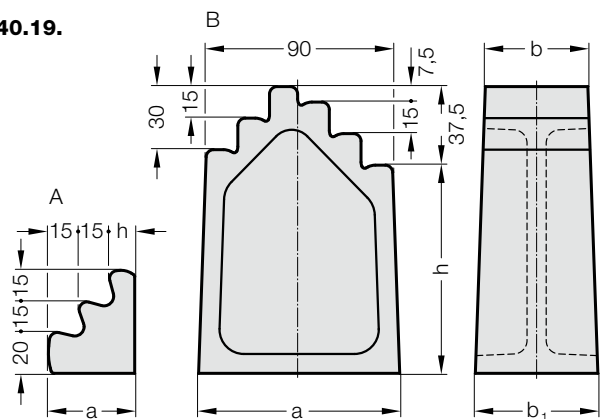

2140.19. Stepped Block DIN 6318

Order No	Ordering size	a	b	b ₁	h	Shape
2140.19.050.050	50	42.5	50	50	12.5	A
2140.19.095.050	95	95	50	55	57.5	B
2140.19.140.050	140	100	50	60	102.5	B
2140.19.185.050	185	105	50	65	147.5	B
2140.19.230.050	230	110	50	70	192.5	B
2140.19.275.050	275	115	50	75	237.5	B
2140.19.050.080	50	42.5	80	80	12.5	A
2140.19.095.080	95	95	80	85	57.5	B
2140.19.140.080	140	100	80	90	102.5	B