

圆柱销 类似于 DIN EN ISO 8734

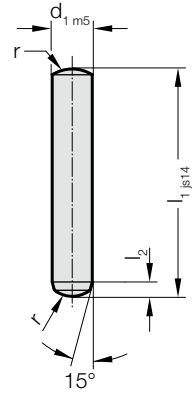

235.1.



材料:

钢

硬度 60 ± 2 HRC

结构:

淬火处理, 精磨。

FIBRO - 精密圆柱销, 其结构形式 适合精密模具制造独特的要求。按标准

DIN EN ISO 8734 允许直径 公差为 m6, 我公司将允许直径公差压缩到 m5。

235.1. 圆柱销 类似于 DIN EN ISO 8734

d_1	l_2	r	l_1	6	8	10	12	14	16	18	20	24	28	32	36	40	45	50	55	60	70	80	90	100	120	130	140
1	0.48	1			●	●	●																				
1.5	0.62	1.6		●	●	●	●	●	●																		
2	0.78	2		●	●	●	●	●	●	●	●	●	●	●													
2.5	0.95	2.5		●	●	●	●	●	●	●	●	●	●	●	●												
3	1.1	3		●	●	●	●	●	●	●	●	●	●	●	●	●	●										
4	1.4	4		●	●	●	●	●	●	●	●	●	●	●	●	●	●	●	●								
5	1.7	5			●	●	●	●	●	●	●	●	●	●	●	●	●	●	●	●	●						
6	2.1	6				●	●	●	●	●	●	●	●	●	●	●	●	●	●	●	●	●	●	●	●	●	●
8	2.6	8					●	●	●	●	●	●	●	●	●	●	●	●	●	●	●	●	●	●	●	●	●
10	3	10						●	●	●	●	●	●	●	●	●	●	●	●	●	●	●	●	●	●	●	●
12	3.8	12							●	●	●	●	●	●	●	●	●	●	●	●	●	●	●	●	●	●	●
14	3.8	16								●	●	●	●	●	●	●	●	●	●	●	●	●	●	●	●	●	●
16	4.7	16									●	●	●	●	●	●	●	●	●	●	●	●	●	●	●	●	●
20	6	20										●	●	●	●	●	●	●	●	●	●	●	●	●	●	●	●

订购示例:

圆柱销 类似于 DIN EN ISO 8734	=	235.1.
直径 d_1	6 mm =	0600.
长度 l_1	10 mm =	010
订购编号	=	235.1.0600. 010