

EJECTOR PIN, HARDENED, DIN 1530-1 SHAPE A

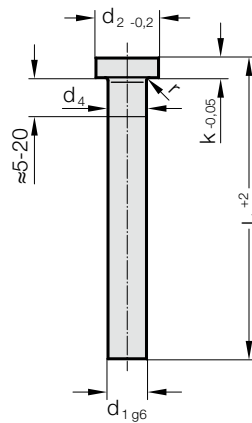

237.1.



Material:

WS
Order No 237.1.
Hardness:
Shaft 60 ± 2 HRC
Head 45 ± 5 HRC

Description of FIBRO materials for tool and die components see at the beginning of Chapter E.

Execution:

Shaft precision ground, hardened.
Head hot dipped and tempered.
The compression thickening below the head is omitted depending on the manufacturing process.

d_4 : For $d_1 < 5$ mm, $d_4 = d_1 + 0,03$
For $d_1 \geq 5$ mm, $d_4 = d_1 + 0,04$
for $d_1 \geq 18$ mm, $d_4 = d_1 + 0,07$

237.1. Ejector pin, hardened, DIN 1530-1 Shape A

d_1	d_2	k	r	l_1	40	63	80	100	125	160	200	250	315	400	500
1	2.5	1.2	0.2		●	●	●	●	●	●	●				
1.1	2.5	1.2	0.2		●	●	●	●	●	●	●				
1.2	2.5	1.2	0.2		●	●	●	●	●	●	●				
1.3	3	1.5	0.2		●	●	●	●	●	●	●				
1.4	3	1.5	0.2		●	●	●	●	●	●	●				
1.5	3	1.5	0.2		●	●	●	●	●	●	●				
1.6	3	1.5	0.2		●	●	●	●	●	●	●				
1.7	3	1.5	0.2		●	●	●	●	●	●	●				
1.8	3	1.5	0.2		●	●	●	●	●	●	●				
1.9	3	1.5	0.2		●	●	●	●	●	●	●				
2	4	2	0.2		●	●	●	●	●	●	●	●	●		
2.2	4	2	0.2		●	●	●	●	●	●	●	●	●		
2.5	5	2	0.3		●	●	●	●	●	●	●	●	●		
2.7	5	2	0.3		●	●	●	●	●	●	●	●	●		
3	6	3	0.3		●	●	●	●	●	●	●	●	●	●	●
3.2	6	3	0.3		●	●	●	●	●	●	●	●	●	●	●
3.5	7	3	0.3		●	●	●	●	●	●	●	●	●	●	●
3.7	7	3	0.3		●	●	●	●	●	●	●	●	●	●	●
4	8	3	0.3		●	●	●	●	●	●	●	●	●	●	●
4.2	8	3	0.3		●	●	●	●	●	●	●	●	●	●	●
4.5	8	3	0.3		●	●	●	●	●	●	●	●	●	●	●
4.7	8	3	0.3		●	●	●	●	●	●	●	●	●	●	●

Ordering Code (example):

Ejector pin, hardened, DIN 1530-1 Shape A =237.1.
Shaft diameter d_1 5 mm = 0500.
Length l_1 40 mm = 040
Order No =237.1. 0500. 040

EJECTOR PIN, HARDENED, DIN 1530-1 SHAPE A

Material:

WS
 Order No 237.1.
 Hardness:
 Shaft 60 ± 2 HRC
 Head 45 ± 5 HRC

237.1.

Description of FIBRO materials for tool and die components see at the beginning of Chapter E.

Execution:

Shaft precision ground, hardened.
 Head hot dipped and tempered.
 The compression thickening below the head is omitted depending on the manufacturing process.

d_4 : For $d_1 < 5$ mm, $d_4 = d_1 + 0.03$
 For $d_1 \geq 5$ mm, $d_4 = d_1 + 0.04$
 for $d_1 \geq 18$ mm, $d_4 = d_1 + 0.07$

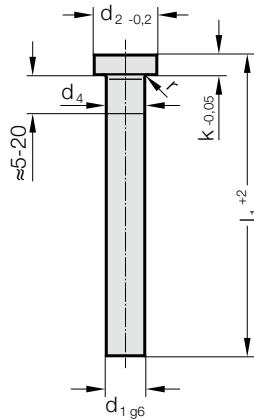

237.1. Ejector pin, hardened, DIN 1530-1 Shape A

d_1	d_2	k	r	l_1	40	63	80	100	125	160	200	250	315	400	500	630	800
5	10	3	0.3		●	●	●	●	●	●	●	●	●	●	●	●	●
5.2	10	3	0.3					●	●	●	●	●	●	●	●		
5.5	10	3	0.3					●	●	●	●	●	●	●	●		
6	12	5	0.5		●	●	●	●	●	●	●	●	●	●	●	●	●
6.2	12	5	0.5					●	●	●	●	●	●	●	●	●	●
6.5	12	5	0.5					●	●	●	●	●	●	●	●	●	●
7	12	5	0.5					●	●	●	●	●	●	●	●	●	●
8	14	5	0.5			●	●	●	●	●	●	●	●	●	●	●	●
8.2	14	5	0.5					●	●	●	●	●	●	●	●	●	●
8.5	14	5	0.5					●	●	●	●	●	●	●	●	●	●
9	14	5	0.5					●	●	●	●	●	●	●	●	●	●
10	16	5	0.5				●	●	●	●	●	●	●	●	●	●	●
10.2	16	5	0.5					●	●	●	●	●	●	●	●	●	●
10.5	16	5	0.5					●	●	●	●	●	●	●	●	●	●
11	16	5	0.5					●	●	●	●	●	●	●	●	●	●
12	18	7	0.8				●	●	●	●	●	●	●	●	●	●	●
12.2	18	7	0.8					●	●	●	●	●	●	●	●	●	●
12.5	18	7	0.8					●	●	●	●	●	●	●	●	●	●
14	22	7	0.8				●	●	●	●	●	●	●	●	●	●	●
16	22	7	0.8					●	●	●	●	●	●	●	●	●	●
18	24	7	0.8					●	●	●	●	●	●	●	●	●	●
20	26	8	1					●	●	●	●	●	●	●	●	●	●

Ordering Code (example):

Ejector pin, hardened, DIN 1530-1 Shape A	=237.1.
Shaft diameter d_1	5 mm = 0500.
Length l_1	40 mm = 040
Order No	=237.1. 0500. 040