

EJECTOR PIN, HARDENED, DIN 1530-3 SHAPE D

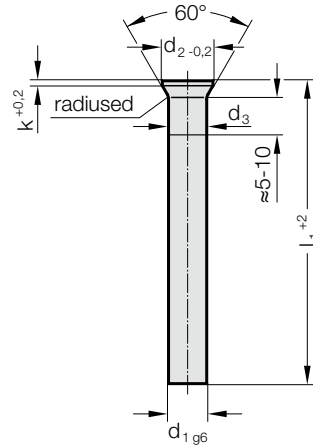

239.1.



Material:

WS
 Order No 239.1.
 Hardness:
 Shaft 60 ± 2 HRC
 Head 45 ± 5 HRC

Description of FIBRO materials for tool and die components see at the beginning of Chapter E.

Execution:

Shaft precision ground, hardened.
 Head hot dipped and tempered.
 The compression thickening below the head is omitted depending on the manufacturing process.

d_3 : For $d_1 < 5$ mm, $d_3 = d_1 + 0,03$
 For $d_1 \geq 5$ mm, $d_3 = d_1 + 0.04$
 for $d_1 \geq 18$ mm, $d_3 = d_1 + 0.07$

239.1. Ejector pin, hardened, DIN 1530-3 Shape D

d ₁	d ₂	k	l ₁	40	60	71	80	100	125	160	200	250	315
0.8	1.4	0.5						•	•	•	•		
0.9	1.6	0.5						•	•	•	•		
1	1.8	0.5		•	•	•	•	•	•	•	•		
1.1	1.8	0.5				•	•	•	•	•	•		
1.2	2	0.5				•		•	•	•	•		
1.25	2	0.5						•	•	•	•		
1.3	2	0.5				•		•	•	•	•		
1.4	2.2	0.5				•		•	•	•	•		
1.5	2.2	0.5		•	•	•	•	•	•	•	•		
1.6	2.5	0.5				•		•	•	•	•		
1.7	2.5	0.5				•		•	•	•	•		
1.75	2.8	0.5				•		•	•	•	•		
1.8	2.8	0.5				•		•	•	•	•		
1.9	2.8	0.5				•		•	•	•	•		
2	3	0.5		•	•	•	•	•	•	•	•	•	
2.1	3.2	0.5				•		•	•	•	•		
2.2	3.2	0.5				•		•	•	•	•	•	
2.25	3.2	0.5				•		•	•	•	•		
2.3	3.5	0.5				•		•	•	•	•		
2.4	3.5	0.5				•		•	•	•	•		
2.5	3.5	0.5		•	•	•	•	•	•	•	•	•	
2.6	4	0.5				•		•	•	•	•		
2.7	4	0.5				•		•	•	•	•	•	
2.75	4	0.5				•		•	•	•	•		
2.8	4	0.5				•		•	•	•	•		
2.9	4	0.5				•		•	•	•	•		
3	4.5	0.5		•	•	•	•	•	•	•	•	•	•
3.1	4.5	0.5				•		•	•	•	•		
3.2	4.5	0.5				•		•	•	•	•		

Ordering Code (example):

Ejector pin, hardened, DIN 1530-3 Shape D	=239.1.
Shaft diameter d ₁	3,2 mm = 0320.
Length l ₁	71 mm = 071
Order No	=239.1. 0320. 071

EJECTOR PIN, HARDENED, DIN 1530-3 SHAPE D

Material:

WS
 Order No 239.1.
 Hardness:
 Shaft 60 ± 2 HRC
 Head 45 ± 5 HRC

Description of FIBRO materials for tool and die components see at the beginning of Chapter E.

Execution:

Shaft precision ground, hardened.
 Head hot dipped and tempered.
 The compression thickening below the head is omitted depending on the manufacturing process.

d_3 : For $d_1 < 5$ mm, $d_3 = d_1 + 0.03$
 For $d_1 \geq 5$ mm, $d_3 = d_1 + 0.04$
 for $d_1 \geq 18$ mm, $d_3 = d_1 + 0.07$

239.1.

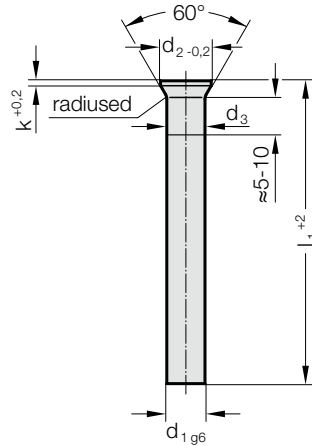

239.1. Ejector pin, hardened, DIN 1530-3 Shape D

d_1	d_2	k	l_1	40	60	71	80	100	125	160	200	250	315
3.25	4.5	0.5				●		●		●	●		
3.5	5	0.5				●	●	●	●	●	●	●	●
3.6	5	0.5				●		●	●	●	●		
3.75	5	0.5						●	●	●	●		
4	5.5	0.5		●	●	●	●	●	●	●	●	●	●
4.1	5.5	0.5				●		●	●	●	●		
4.2	5.5	0.5				●		●	●	●	●		
4.25	5.5	0.5						●	●	●	●		
4.5	6	0.5				●		●	●	●	●		
4.6	6	0.5				●		●	●	●	●		
5	6.5	0.5		●	●	●	●	●	●	●	●	●	●
5.1	6.5	0.5				●		●	●	●	●		
5.2	6.5	0.5				●		●	●	●	●		
5.25	6.5	0.5						●	●	●	●		
5.5	7	0.5			●	●	●	●	●	●	●	●	●
6	8	0.5		●	●	●	●	●	●	●	●	●	●
6.2	8	1				●	●	●	●	●	●	●	●
6.5	9	1				●	●	●	●	●	●	●	●
7	9	1				●	●	●	●	●	●	●	●
7.5	10	1				●	●	●	●	●	●	●	●
8	10	1			●	●	●	●	●	●	●	●	●
8.2	10	1						●	●	●	●	●	●
8.5	11	1				●		●	●	●	●	●	●
9	11	1				●		●	●	●	●	●	●
10	12	1				●	●	●	●	●	●	●	●
12	14	1					●	●	●	●	●	●	●
14	16	1.5						●	●	●	●	●	●
16	18	1.5						●	●	●	●	●	●

Ordering Code (example):

Ejector pin, hardened, DIN 1530-3 Shape D	=239.1.
Shaft diameter d_1	3.2 mm = 0320.
Length l_1	71 mm = 071
Order No	=239.1. 0320. 071