

# SHOULDER SCREW

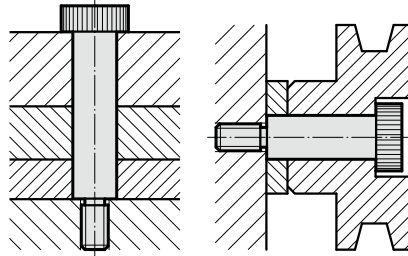

Mounting example



244.17.

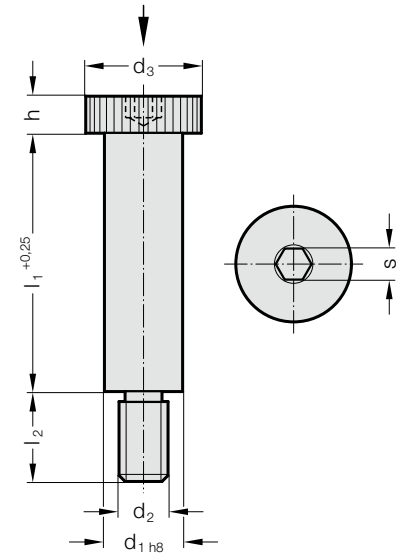

**Material:**

High tensile steel,  
heat treated to 12.9 ISO 898-1.

**Execution:**

d<sub>1</sub> ground,  
heads knurled.

**244.17. Shoulder screw**

d <sub>1</sub>	6	8	10	12	16	20	24
d <sub>2</sub>	M5	M6	M8	M10	M12	M16	M20
Tightening torque [Nm]	7	13	32	65	120	290	500
d <sub>3</sub>	10	13	16	18	24	30	36
h	4.5	5.5	7	9	11	14	16
s	3	4	5	6	8	10	12
l <sub>2</sub>	9.5	11	13	16	18	22	27
l <sub>1</sub>							
10	●	●					
12	●	●					
16	●	●		●			
20	●	●	●	●			
25	●	●	●	●	●		
30	●	●	●	●	●	●	
35	●	●	●	●	●	●	
40	●	●	●	●	●	●	●
45			●	●	●	●	●
50		●	●	●	●	●	●
55			●	●	●	●	●
60			●	●	●	●	●
65			●	●	●	●	●
70			●	●	●	●	●
80			●	●	●	●	●
90				●	●	●	●
100				●	●	●	●
120					●	●	●

**Ordering Code (example):**

Shoulder screw	=244.17.
Nominal diameter d <sub>1</sub> 12 mm	= 120.
Guide length l <sub>1</sub> 55 mm	= 055
Order No	=244.17. 120.055