

橡胶圆弹簧 70 肖氏硬度 A

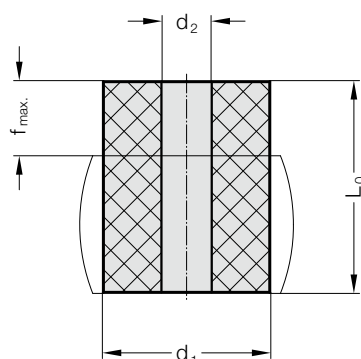

2461.2.



材料:

氯丁橡胶 70 肖氏硬度 A

颜色: 黑色

说明:

由于其物理性能的缘故, 合成橡胶弹簧有一种收缩(下沉)倾向。这种收缩倾向与材料的内摩擦热、负荷交变 速度和次数、弹簧变形量和肖氏硬度有关。

收缩可达弹簧长度 L_0 的 3-5 %。

物理特性:

抗拉强度符合 DIN 53504 标准: $\geq 12 \text{ N/mm}^2$

断裂伸长率符合 DIN 53504 标准: $\geq 250 \%$

总密度符合 DIN 53479 标准: 1.37 g/cm^3

压力变形差符合 DIN 53517 标准: $\leq 20 \%$ (24 h/70 °C)

温度应用范围: -20 °C 至 80 °C 短时间内最大为 120 °C

2461.2. 橡胶圆弹簧 70 肖氏硬度 A

订购编号	d_1	L_0	d_2	$f_{max.}$	订购编号	d_1	L_0	d_2	$f_{max.}$
2461.2.016.012	16	12	6.5	4.8	2461.2.063.100	63	100	17	40
2461.2.016.016	16	16	6.5	6.4	2461.2.063.125	63	125	17	50
2461.2.016.020	16	20	6.5	8	2461.2.080.032	80	32	21	12.8
2461.2.016.025	16	25	6.5	10	2461.2.080.040	80	40	21	16
2461.2.020.016	20	16	8.5	6.4	2461.2.080.050	80	50	21	20
2461.2.020.020	20	20	8.5	8	2461.2.080.063	80	63	21	25.2
2461.2.020.025	20	25	8.5	10	2461.2.080.080	80	80	21	32
2461.2.020.032	20	32	8.5	12.8	2461.2.080.100	80	100	21	40
2461.2.025.020	25	20	10.5	8	2461.2.080.125	80	125	21	50
2461.2.025.025	25	25	10.5	10	2461.2.100.032	100	32	21	12.8
2461.2.025.032	25	32	10.5	12.8	2461.2.100.040	100	40	21	16
2461.2.025.040	25	40	10.5	16	2461.2.100.050	100	50	21	20
2461.2.032.032	32	32	13.5	12.8	2461.2.100.063	100	63	21	25.2
2461.2.032.040	32	40	13.5	16	2461.2.100.080	100	80	21	32
2461.2.032.050	32	50	13.5	20	2461.2.100.100	100	100	21	40
2461.2.032.063	32	63	13.5	25.2	2461.2.100.125	100	125	21	50
2461.2.040.032	40	32	13.5	12.8	2461.2.125.032	125	32	27	12.8
2461.2.040.040	40	40	13.5	16	2461.2.125.040	125	40	27	16
2461.2.040.050	40	50	13.5	20	2461.2.125.050	125	50	27	20
2461.2.040.063	40	63	13.5	25.2	2461.2.125.063	125	63	27	25.2
2461.2.040.080	40	80	13.5	32	2461.2.125.080	125	80	27	32
2461.2.050.032	50	32	17	12.8	2461.2.125.100	125	100	27	40
2461.2.050.040	50	40	17	16	2461.2.125.125	125	125	27	50
2461.2.050.050	50	50	17	20	2461.2.125.160	125	160	27	64
2461.2.050.063	50	63	17	25.2					
2461.2.050.080	50	80	17	32					
2461.2.050.100	50	100	17	40					
2461.2.063.032	63	32	17	12.8					
2461.2.063.040	63	40	17	16					
2461.2.063.050	63	50	17	20					
2461.2.063.063	63	63	17	25.2					
2461.2.063.080	63	80	17	32					

2461.2.016.

Ø 16/70 Shore A

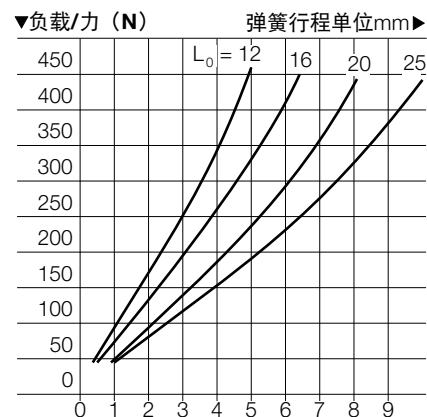



橡胶圆弹簧 70 肖氏硬度 A

2461.2.020.
Ø 20/70 Shore A

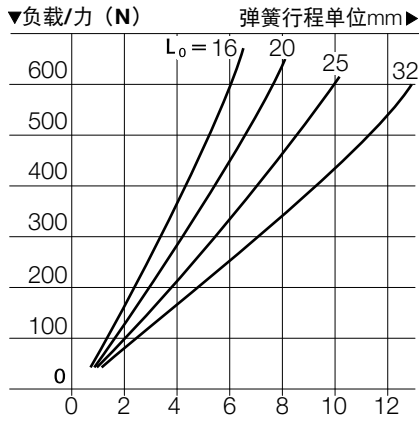

2461.2.025.
Ø 25/70 Shore A

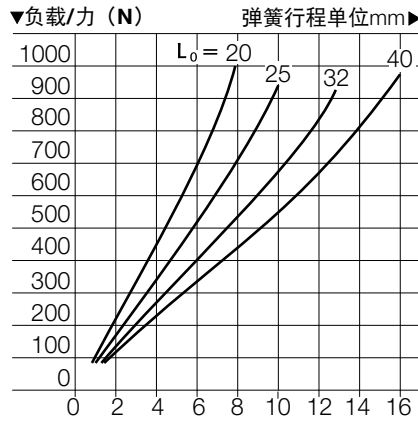

2461.2.032.
Ø 32/70 Shore A

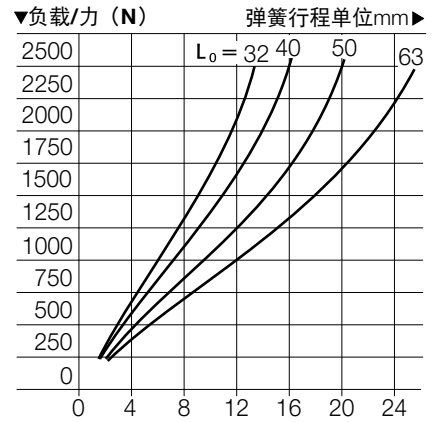

2461.2.040.
Ø 40/70 Shore A

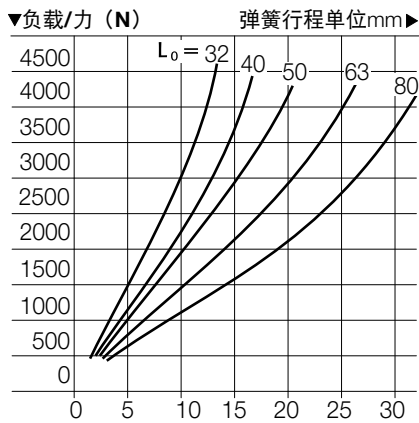

2461.2.050.
Ø 50/70 Shore A

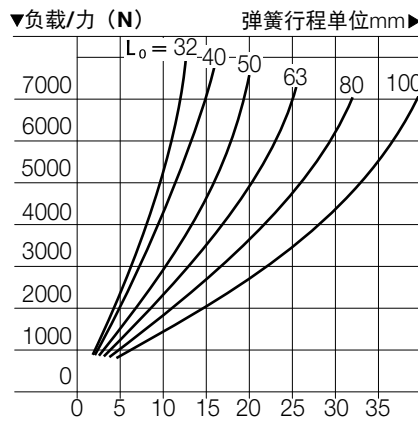

2461.2.063.
Ø 63/70 Shore A

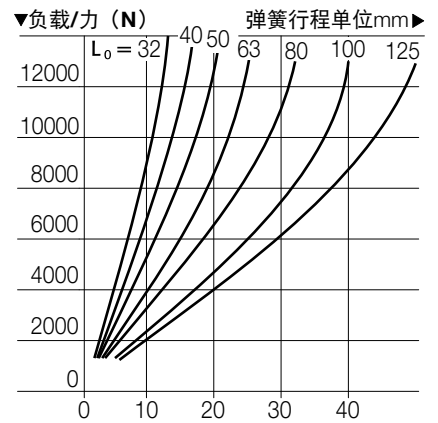

2461.2.080.
Ø 80/70 Shore A

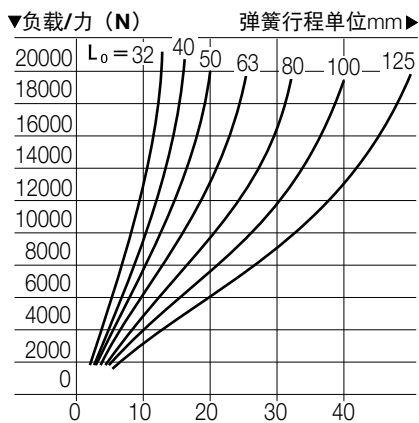

2461.2.100.
Ø 100/70 Shore A

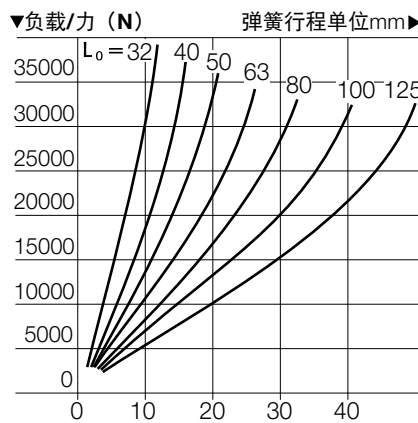

2461.2.125.
Ø 125/70 Shore A

