

LIFTER UNIT WITH PILLAR GUIDANCE

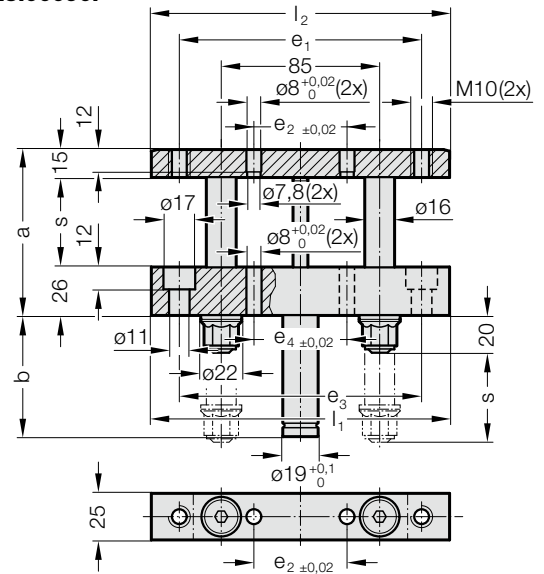

2478.25.00090.



Description:

Filling pressure regulation and a composite arrangement are possible using the cylinder tube base. To attach the strip guide on the lifter rail, use the provided threads. We recommend designing the strip guide for a maximum material width of +0.4 mm (0.2 mm for each side) (View X). When several lifter units are used, only one unit per piece should be pinned in order to prevent redundancy.

Note:

The lifter unit is equipped with gas spring type 2482.74.00090, which cannot be repaired in case of wear and must therefore be exchanged completely.

Initial spring force: 90 daN

Pressure medium: Nitrogen N₂

Max. filling pressure: 180 bar

Min. filling pressure: 25 bar

Working temperature: 0°C to +80°C

Temperature related force increase: ± 0.3%/°C

Max. recommended extensions per minute:

approx. 40 to 100 (at 20°C)

Max. piston speed: see diagram

Max. usable stroke: 95%

Spring forces as per spring diagram in Chapter F - 2482.74.

2478.25.00090. Lifter unit with pillar guidance

Order No	s Stroke max.	a	b	l ₁	l ₂	e ₁	e ₂	e ₃	e ₄	Spring force [daN]		Gas spring
										initial	final	
2478.25.00090.025	23	64	40	160	115	50	25	130	50	90	130	2482.74.00090.025.2
2478.25.00090.038	36	77	53	160	160	130	50	130	50	90	120	2482.74.00090.038.2
2478.25.00090.050	48	89	65	160	160	130	50	130	50	90	120	2482.74.00090.050.2
2478.25.00090.063	61.5	102.5	81.5	160	160	130	50	130	50	90	120	2482.74.00090.063.2
2478.25.00090.080	78	119	98	160	160	130	50	130	50	90	120	2482.74.00090.080.2
2478.25.00090.100	98	139	118	160	160	130	50	130	50	90	120	2482.74.00090.100.2
2478.25.00090.125	123	164	143	160	160	130	50	130	50	90	120	2482.74.00090.125.2
2478.25.00090.150	148	189	168	160	160	130	50	130	50	90	120	2482.74.00090.150.2

2478.25.00090.

Max. load per lifter unit**

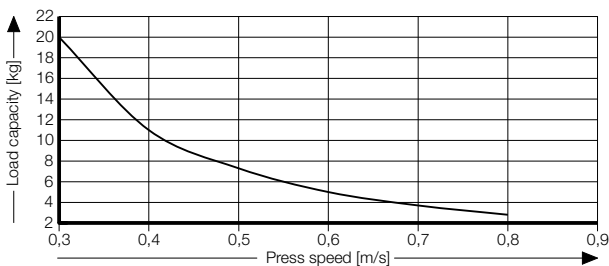

** Only recommended load capacity (per lifter unit) depending on the press speed. Provide an external stop in case of higher loads.

Mounting example

