

## GUIDE BUSH FOR PUNCH, ISO 8978

2621.

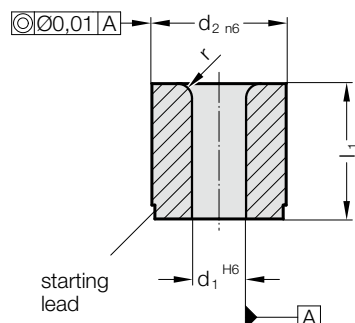

### Material:

WS

Hardness  $60 \pm 2$  HRC

 Description of FIBRO materials for tool and die components see at the beginning of Chapter E.

### Execution:

Diameters  $d_1$ ,  $d_2$  and starting lead ground.

### 2621. Guide bush for punch, ISO 8978

Gradation				
$d_1$	$d_1$	$d_2$	$l_1$	$r$
1 - 2,4	0.1	5	8	1
1,6 - 3	0.1	6	12.5	1
2 - 3,5	0.1	8	12.5	1.5
3 - 5	0.1	10	16	2
4 - 7,2	0.1	13	16	2
6 - 8,8	0.1	16	20	2
7,5 - 11,3	0.1	20	20	2.5
11 - 16,6	0.1	25	25	2.5
15 - 20	0.5	32	25	4
18 - 27	0.5	40	32	4
26 - 36	0.5	50	40	4

### Ordering Code (example):

Guide bush for punch, ISO 8978	=	2621.1.
Diameter of conduit $d_1$	6 mm =	0600.
Outer diameter $d_2$	16 mm =	1600
Order No	=	2621.1. 0600. 1600