



Blind Rivet Nut EFM-G

Series 10.860

Stainless Steel A2

- > Flat Head
- > Round Shank
- > Closed

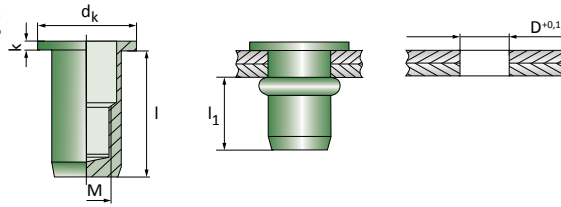

[1.4567]

M		l	No.	
M4	0,5 - 2,5	16,0	10.860.040.250	500
D 6,0	k 1,0	dk 9,0	li max. 13,0	4 Nm 7000 N
M5	0,5 - 3,0	18,0	10.860.050.300	500
D 7,0	k 1,0	dk 10,0	li max. 14,5	6 Nm 11000 N
M6	0,5 - 3,0	21,0	10.860.060.300	500
D 9,0	k 1,5	dk 12,0	li max. 16,0	11 Nm 18000 N

M		l	No.	
M8	0,5 - 3,0	23,5	10.860.080.300	250
D 11,0	k 1,5	dk 15,0	li max. 19,0	24 Nm 27000 N
M10	1,0 - 3,5	26,5	10.860.100.350	100
D 13,0	k 2,0	dk 17,0	li max. 21,0	50 Nm 40000 N

NEW