



Blind Rivet Nut SFM-G

Series 10.856



Steel

- > Flat Head
- > Round Shank
- > Closed

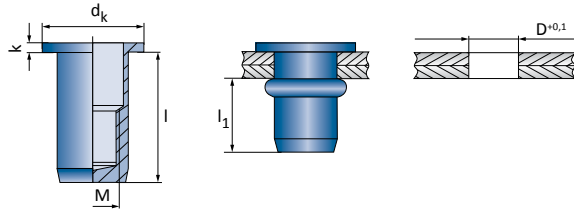

C4C [1.0303]

M		I	No.		
M5	0,5 - 3,0	18,5	10.856.050.300	500	
	3,0 - 5,5	21,0	10.856.050.550	500	
D 7,0	k 1,0	dk 11,0	li max. 15,5	6 Nm	9500 N
M6	0,5 - 3,0	22,5	10.856.060.300	500	
	D 9,0	k 1,2	dk 12,0	li max. 16,0	11 Nm

M		I	No.		
M8	0,5 - 3,5	26,5	10.856.080.350	250	
	3,5 - 6,0	29,5	10.856.080.600	250	
D 11,0	k 1,3	dk 14,0	li max. 17,5	24 Nm	23500 N
M10	1,0 - 3,0	33,0	10.856.100.300	250	
	D 13,0	k 2,0	dk 19,0	li max. 28,5	50 Nm