

NEW!\*

# DryLin® R | Pressfit Bearing WLM | mm

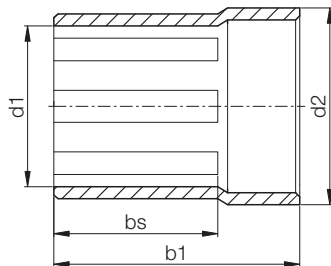
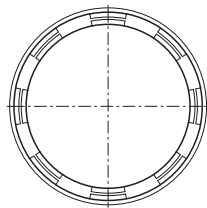

Structure – part no.  
**WLM-0608-10**

- b1
- d2
- d1
- Metric
- Series L1
- Material: iglidur® L100



## Special properties

- Pressfit bearing made of iglidur® L100
- Extremely wear resistant
- Low coefficient of friction
- Recommended tolerance for the shaft: h6–h10 (see iglus® shafts ► **chapter 65**)
- Recommended housing bore H7

\* Measured with a  
plug gauge  
Available from stock

DryLin® R  
mm

Phone +49 - 22 03 - 96 49-145  
Fax +49 - 22 03 - 96 49-334

## Type S – Dimensions [mm]

Part No.	d1 [mm]	Tolerance* [mm]	d2 [mm]	b1 [mm]	bs [mm]
WLM-0608-10	6	+ 0,02 ... + 0,04	8	10	6
WLM-0810-12	8	+ 0,02 ... + 0,04	10	12	8
WLM-1012-14	10	+ 0,02 ... + 0,04	12	14,5	10
WLM-1012-16	10	+ 0,02 ... + 0,04	12	16	10
WLM-1214-16	12	+ 0,02 ... + 0,04	14	16	10
WLM-1214-25	12	+ 0,02 ... + 0,04	14	25	15
WLM-1618-18	16	+ 0,02 ... + 0,04	18	18	10
WLM-1618-26	16	+ 0,02 ... + 0,04	18	26	16
WLM-2023-22	20	+ 0,04 ... + 0,08	23	22,5	12,5
WLM-2023-30	20	+ 0,04 ... + 0,08	23	30	20
WLM-2225-30	22	+ 0,04 ... + 0,08	25	30	20
WLM-2528-29	25	+ 0,04 ... + 0,08	28	29	19
WLM-2528-35	25	+ 0,04 ... + 0,08	28	35	25
WLM-3034-34	30	+ 0,04 ... + 0,08	34	34	24
WLM-3034-40	30	+ 0,04 ... + 0,08	34	40	30
WLM-4044-40	40	+ 0,04 ... + 0,08	44	40	30
WLM-4044-50	40	+ 0,04 ... + 0,08	44	50	40
WLM-5055-50	50	+ 0,04 ... + 0,08	55	50	40
WLM-5055-60	50	+ 0,04 ... + 0,08	55	60	50

