

# drylin® W | Hybrid bearings | Product range

Hybrid carriages – single & double roller bearings for lateral installation

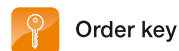

Order key

Type    Dimensions    Option

**WWR-21-80 - 01**

drylin® W	Hybrid carriage	Installation size	Compact
-----------	-----------------	-------------------	---------

Options

- 01: Carriage, short design
- 15: Complete carriage, long design

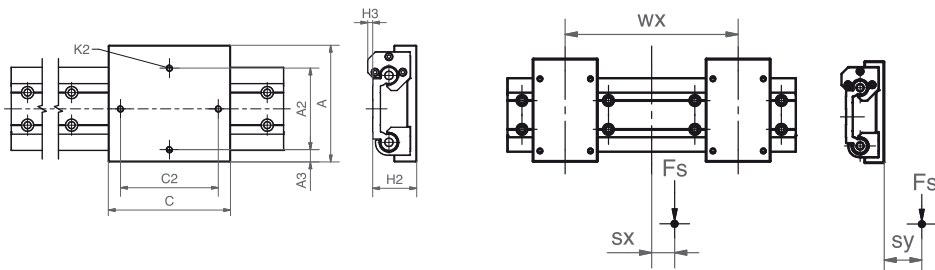

Load data and dimensions [mm]

Part No.	A	C	A2	C2	K2	H2	A3	H3	sx min.	sx max.	sy min.	sy max.
	Width	Length				±0.17						
WWR-21-80-01	143	90	100	70	M8	54	15	6	-49	+49	-34	+34
WWR-21-80-15	143	150	100	120	M8	54	15	6	-wx/2	+wx/2	-34	+34



Order example:

- WWH-10-40-10: Assembled hybrid carriage with 4 single roller hybrid bearings
- WWR-21-80-01: Assembled single hybrid carriage as a "door opener" with 2 single roller hybrid bearings and 2 double roller hybrid bearings

Can be combined with:



# drylin® W | Hybrid bearings | Product range

Hybrid carriages with 4 bearings for horizontal installation



Order key

Type    Dimensions

**WWH-10-40-10**

drylin® W	Hybrid carriage	Installation size	Length of carriage [mm]
-----------	-----------------	-------------------	-------------------------

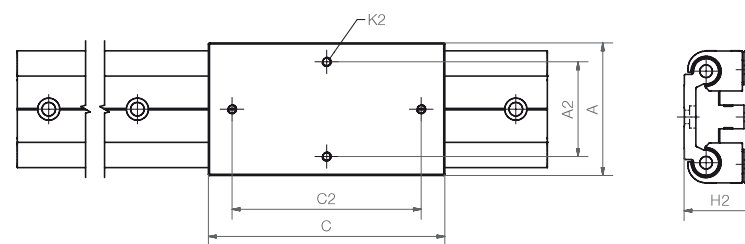

Dimensions [mm]

Part No.	Weight [kg]	A	C	A2	C2	K2	H2	Static load capacity				
							±0.17	Coy [N]	Coz [N]	Mox [Nm]	Moy [Nm]	Moz [Nm]
WWH-10-40-10	0.35	58	100	40	80	M5	34	1,000	1,000	20	16	32
WWH-16-60-15	0.96	84	150	60	120	M6	46	1,600	1,600	45	38	77
WWH-20-80-25	2.05	134	250	116	232	M8	57	3,360	3,360	138	640	640

Can be combined with:

