

The Standard - option polymer - pivoting

- Recommended for unsupported and gliding applications
- Well suited for tight installation conditions
- Strain relief with detachable tiewrap plates
- Variable traverse angle for flexible assembly
- The twistability of the E-Chain® and the option to assemble the mounting brackets on the fixed end and/or the moving end, enable various installation options

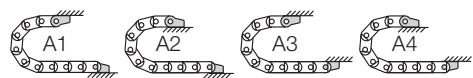

Possible installation conditions for assembled mounting brackets ▶ Order example "preassembled" below

Moving end with bore
(outer link) 2...3PZ(B)+

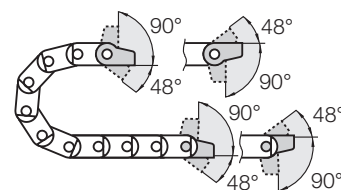

2...4PZ(B)+ Fixed end
with pin (inner link)

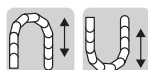

Option polymer - locking

- Recommended for unsupported and gliding applications
- At very high speed and/or acceleration
- If space is limited for height (the H_F measurement)
- The twistability of the E-Chain® and the option to assemble the mounting brackets on the fixed end and/or the moving end, enable various installation options

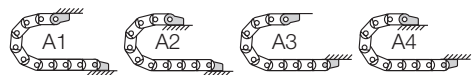

Possible installation conditions for assembled mounting brackets ▶ Order example "preassembled" below

Moving end with bore
(outer link) 2...1PZ(B)+

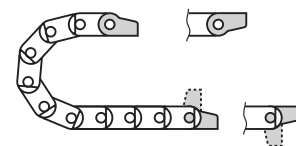

2...2PZ(B)+ Fixed end
with pin (inner link)

Dimensions and order configurations

Strain relief is possible on the moving end and/or the fixed end.

Part No. structure (pivoting)

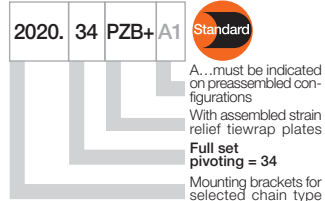

Full set, for both ends:

2020. 34 PZB+ +tiewrap plate

Single-part order:

2020. 3 PZB+ +tiewrap plate

Mounting bracket with bore

2020. 4 PZB+ +tiewrap plate

Mounting bracket with pin

Part No. structure (locking)

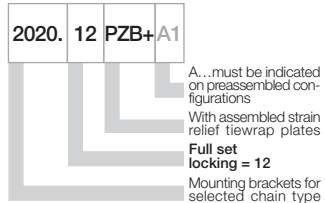

Full set, for both ends:

2020. 12 PZB+ +tiewrap plate

Single-part order:

2020. 1 PZB+ +tiewrap plate

Mounting bracket with bore

2020. 2 PZB+ +tiewrap plate

Mounting bracket with pin

2...3PZ(B)+ Standard! (pivoting)
2...1PZ(B)+ (locking)

Moving end

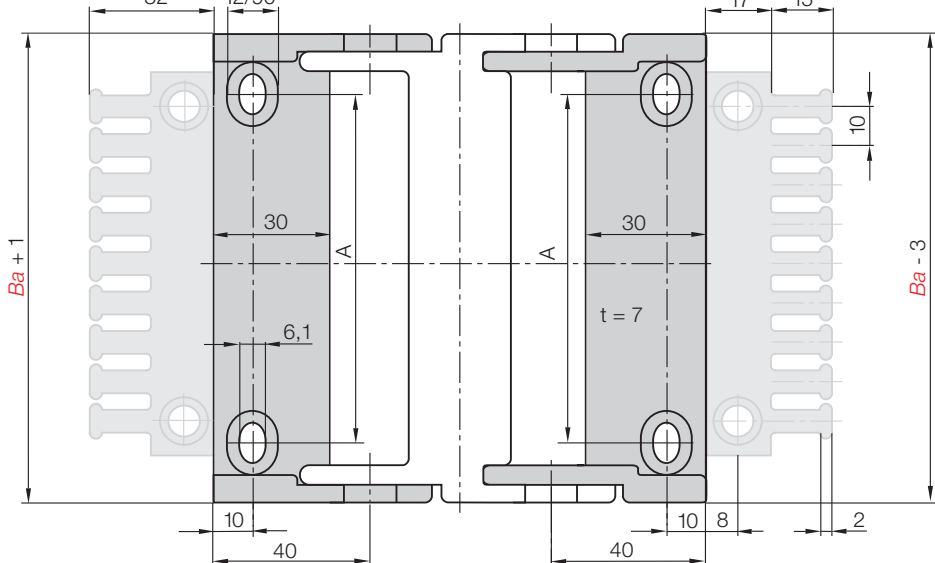

Standard! (pivoting) 2...4PZ(B)+
(locking) 2...2PZ(B)+
Fixed end

For E-Chain®	Part No. full set with tiewrap plate	Part No. with tiewrap plate + 10 cable tiewraps	Part No. full set without tiewrap plate	Dim. A [mm]
2400 - 2500.02 ▶	2020. <input type="checkbox"/> PZB+	2020. <input type="checkbox"/> PZBK1+	2020. <input type="checkbox"/> PZ+	12
2400 - 2500.03 ▶	2030. <input type="checkbox"/> PZB+	2030. <input type="checkbox"/> PZBK1+	2030. <input type="checkbox"/> PZ+	25
2400 - 2500.05 ▶	2050. <input type="checkbox"/> PZB+	2050. <input type="checkbox"/> PZBK1+	2050. <input type="checkbox"/> PZ+	44
2400 - 2500.07 ▶	2070. <input type="checkbox"/> PZB+	2070. <input type="checkbox"/> PZBK1+	2070. <input type="checkbox"/> PZ+	64
2400 - 2500.09 ▶	2090. <input type="checkbox"/> PZB+	2090. <input type="checkbox"/> PZBK1+	2090. <input type="checkbox"/> PZ+	77
2400 - 2500.10 ▶	2100. <input type="checkbox"/> PZB+	2100. <input type="checkbox"/> PZBK1+	2100. <input type="checkbox"/> PZ+	90
2400 - 2500.12 ▶	2125. <input type="checkbox"/> PZB+	2125. <input type="checkbox"/> PZBK1+	2125. <input type="checkbox"/> PZ+	112

Please add the Part No. with the requested index - 34 for the pivoting configuration

e.g. 2020. 34 PZB+ or 12 for the locking configuration e.g. 2020. 12 PZB+

For the preassembled mode please add the index A1...A4 e.g. 2020. 34 PZB+ A1