

The Standard - option polymer - pivoting

- Recommended for unsupported and gliding applications
- Well suited for tight installation conditions
- Strain relief with detachable tiwrap plates
- Variable traverse angle for flexible assembly
- The twistability of the E-Chain® and the option to assemble the mounting brackets on the fixed end and/or the moving end, enable various installation options

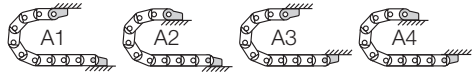

Possible installation conditions for assembled mounting brackets ► Order example "preassembled" below

Moving end with bore
(outer link) 26...3PZ(B)

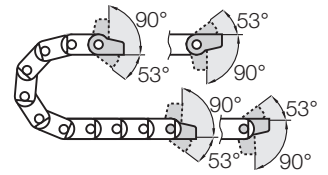

26...4PZ(B) Fixed end
with pin (inner link)

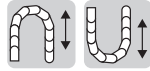

Option polymer - locking

- Recommended for unsupported and gliding applications
- Furthermore:
 - At very high speed and/or acceleration
 - If space is limited for height (the H_F measurement)
 - The twistability of the E-Chain® and the option to assemble the mounting brackets on the fixed end and/or the moving end, enable various installation options

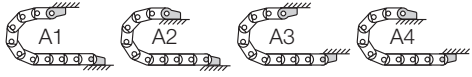

Possible installation conditions for assembled mounting brackets ► Order example "preassembled" below

Moving end with bore
(outer link) 26...1PZ(B)

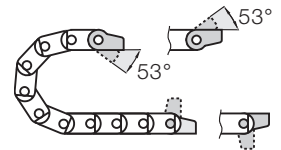

26...2PZ(B) Fixed end
with pin (inner link)

Dimensions and order configurations

Strain relief is possible on the moving end and/or the fixed end.

Part No. structure (pivoting)

2607.	34	PZB	A1	<p>A... must be indicated on preassembled configurations with assembled tiwrap plates</p> <p>Full set pivoting = 34</p> <p>Mounting brackets for selected chain type</p>

Full set, for both ends:

2607. 34 PZB +tiwrap plate

Single-part order:

2607. 3 PZB +tiwrap plate

Mounting bracket with bore

2607. 4 PZB +tiwrap plate

Mounting bracket with pin

Part No. structure (locking)

2607.	12	PZB	A1	<p>A... must be indicated on preassembled configurations with assembled tiwrap plates</p> <p>Full set locking = 12</p> <p>Mounting brackets for selected chain type</p>

Full set, for both ends:

2607. 12 PZB +tiwrap plate

Single-part order:

2607. 1 PZB +tiwrap plate

Mounting bracket with bore

2607. 2 PZB +tiwrap plate

Mounting bracket with pin

26...3PZ(B) Standard! (pivoting)

26...1PZ(B) (locking)

Moving end

Standard! (pivoting) 26...4PZ(B)

(locking) 26...2PZ(B)

Fixed end

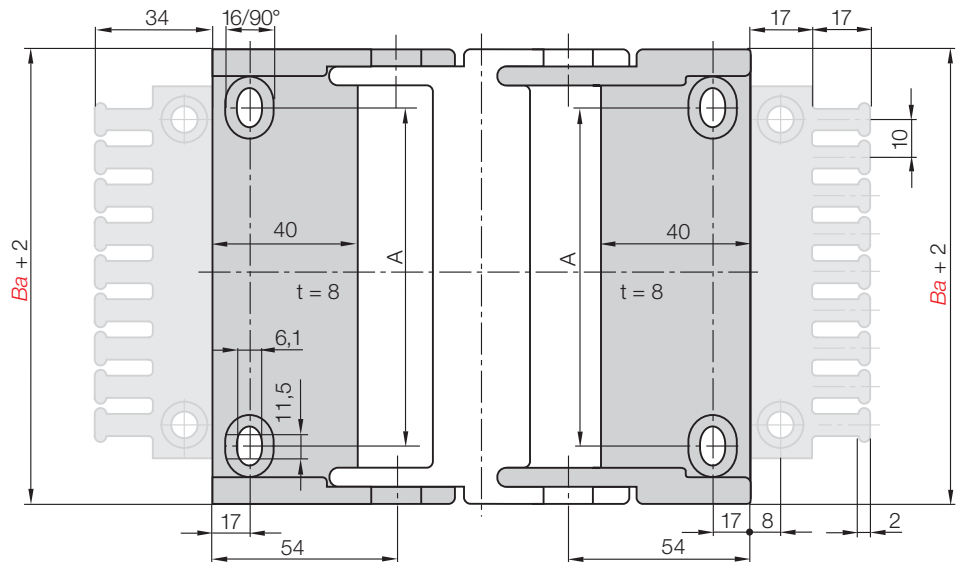

For E-Chain®	Part No. full set with tiwrap plate	Part No. tiwrap plate + 10 cable tiwraps	Part No. full set without tiwrap plate	Number of teeth	Dim. A [mm]
E26-Z26.07	2607. [] PZB	2607. [] PZBK1	2607. [] PZ	7	55
E26-Z26.2/45	2610. [] PZB	2610. [] PZBK1	2610. [] PZ	10	80
E26-Z26.3/45	2615. [] PZB	2615. [] PZBK1	2615. [] PZ	15	130

Please add the Part No. with the requested index - 34 for the pivoting configuration

e.g. 2607. 34 PZB or 12 for the locking configuration e.g. 2607. 12 PZB

For the preassembled mode please add the index A1...A4 e.g. 2607. 34 PZB A1