

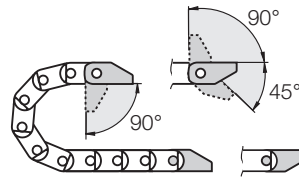

Polymer, one-piece

- One-piece mounting bracket
- Corrosion-resistant
- Available preassembled
- Inner and outer attachment possible

Moving end with bore
(outer link) 050...1



050...2 Fixed end
with pin (inner link)

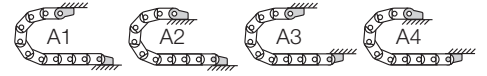

Possible installation conditions for assembled mounting brackets ► Order example "preassembled" below

050...1
Moving end

050...2
Fixed end

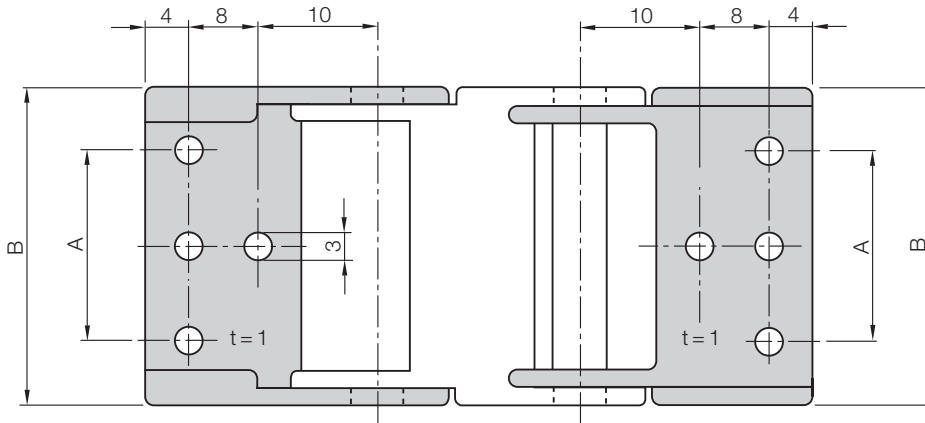

050.06.12 - 050.20.12: center bores only

050.30.12 - 050.64.12: outer bores only

For E-Chain®	Part No. full set	Dim. A [mm]	Dim. B [mm]
05.06. ►	050.06. 12	-	10,7
05.10. ►	050.10. 12	-	14,7
05.16. ►	050.16. 12	-	20,7
05.20. ►	050.20. 12	-	24,7
05.30. ►	050.30. 12	22	34,7
05.64. ►	050.64. 12	56	68,7

For the **preassembled** mode please add the index **A1** ... **A4** e.g. 050.20. 12 **A1**

Dimensions and order configurations

Part No. structure

050.	20.	12	A1
------	-----	----	----

A... must be indicated on preassembled configurations

Full set = 12

Width Mounting brackets for selected chain type

Full set, for both ends:

050. 20. 12

Single-part order:

050. 20. 1

Mounting bracket with bore

050. 20. 2

Mounting bracket with pin

Phone +49- (0) 22 03-96 49-800
Fax +49- (0) 22 03-96 49-222

