

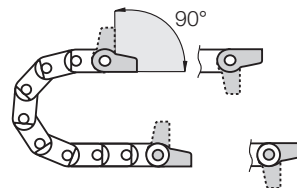

Option Polymer, one-piece

- One-piece mounting bracket
- Corrosion-resistant
- Available preassembled
- Inner and outer attachment possible
- Available with or without strain relief tiewrap plates

Moving end with bore
(outer link) 114...1P(Z)



114...2P(Z) Fixed end
with pin (inner link)

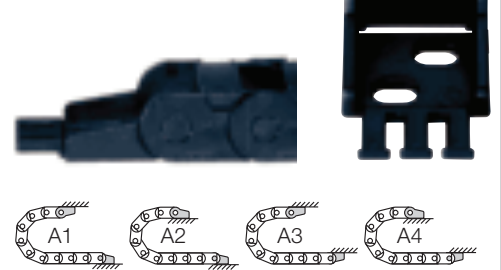

Possible installation conditions for assembled mounting brackets ▶ Order example "preassembled" below

114...1P(Z)
Moving end

114...2P(Z)
Fixed end

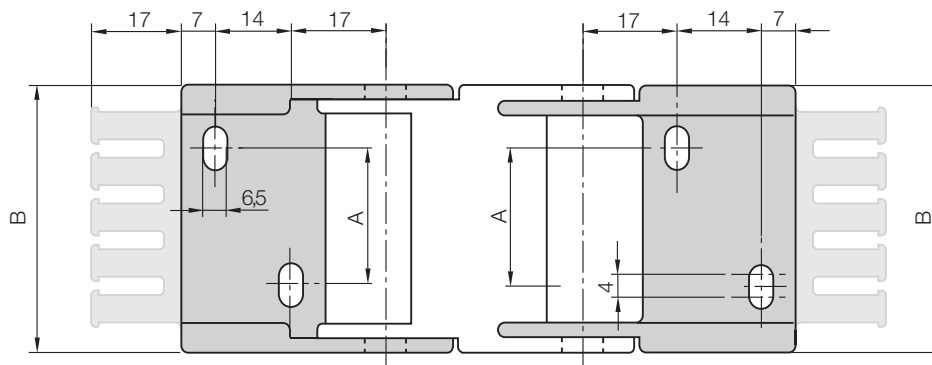

Dimensions and order configurations

Strain relief is possible on the moving end and/or the fixed end.

Part No. structure

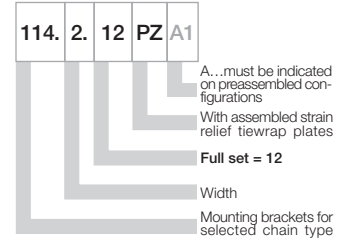

For E-Chain®	Part No. full set with tiewrap plate	Part No. full set without tiewrap plate	Dim. A [mm]	Dim. B [mm]
14.1. ▶	114.1. 12 PZ	114.1. 12 P	-	26,3
14.2. ▶	114.2. 12 PZ	114.2. 12 P	10	36,3
14.3. ▶	114.3. 12 PZ	114.3. 12 P	23	49,3
14.4. ▶	114.4. 12 PZ	114.4. 12 P	35	61,3

For the **preassembled** mode please add the index **A1**... **A4** e.g. 114.2. 12 PZ **A1**

Full set, for both ends:

114. 2. 12 PZ +tiewrap plate

Single-part order:

114. 2. 1 PZ +tiewrap plate

Mounting bracket with bore

114. 2. 2 PZ +tiewrap plate

Mounting bracket with pin

Phone +49- (0) 22 03-96 49-800
Fax +49- (0) 22 03-96 49-222



Quicksnap - the complete, detachable mounting unit, upon request



Quickfix - mounting bracket with dowel, upon request

Additional Features

