

**lifgo® gear racks 5.0 - 5.4 • dimension sheet**

The gear rack bears guide loads. It is subjected to tensile, compressive, and transverse forces. Note the moments of inertia and the torque loads on the gearboxes (see Page 68.) The gear rack is symmetrical in construction.

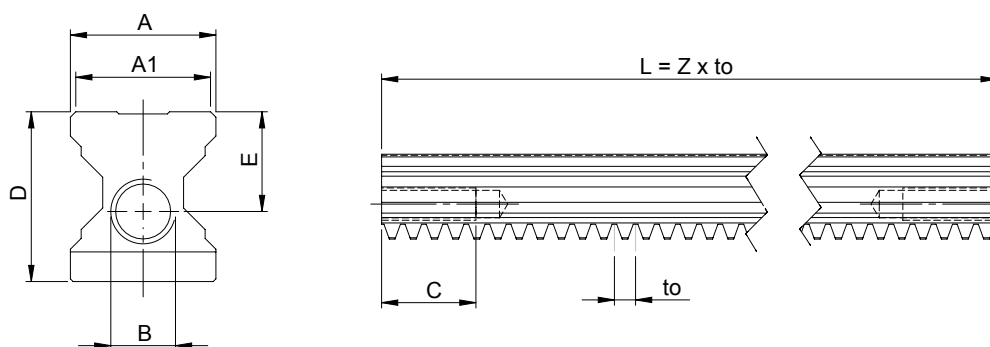

**!** When a gear rack protection is used, the gear rack length increases by the installed length of the protection. **For heavy loads, we recommend the use of hardened & ground gear racks.** Have the theoretical lifespan calculated.

Always add the number of teeth "Z = \_ \_ \_" to the article number.

Lifgo® gear racks	unit	5.0	5.1	5.3	5.4
A	mm	23	27	48	68
A1	mm	21	25	46	66
B	mm	M10	M12	M20	M24
C	mm	20	25	35	40
D	mm	26	31.5	48.5	48.5
E	mm	16	18.5	26.5	26.5
Gear rack length	L mm	$L = Z \times to$	$L = Z \times to$	$L = Z \times to$	$L = Z \times to$
Number of teeth	Z	as per customer data	as per customer data	as per customer data	as per customer data
Module	m	1.0	2.5	2.5	2.5
Tooth pitch	to mm	$to = m \times Pi$	$to = m \times Pi$	$to = m \times Pi$	$to = m \times Pi$
Moment of inertia	lx mm <sup>4</sup>	16411	22961	253179	428881
Moment of inertia	ly mm <sup>4</sup>	24216	35018	297984	809895
Polar moment of inertia	lp mm <sup>4</sup>	40628	57979	551164	1238776
Weight	kg/m	3.82	4.84	14.45	21.61

Article number		5.0	5.1	5.3	5.4
Lifgo® gear rack		500 113	500 114	500 115	500 116
Lifgo® gear rack	ground	500 504	500 505	500 506	500 637
Lifgo® gear rack	hardened&ground	500 169	500 170	500 171	500 172