

3.1.3.5 lifgo® linear gear rack protection & end plate • Dimension sheet

This gear rack protection is not suitable for use in welding areas. The end plate is used for mounting the gear rack protection on the lifgo® linear gear rack.

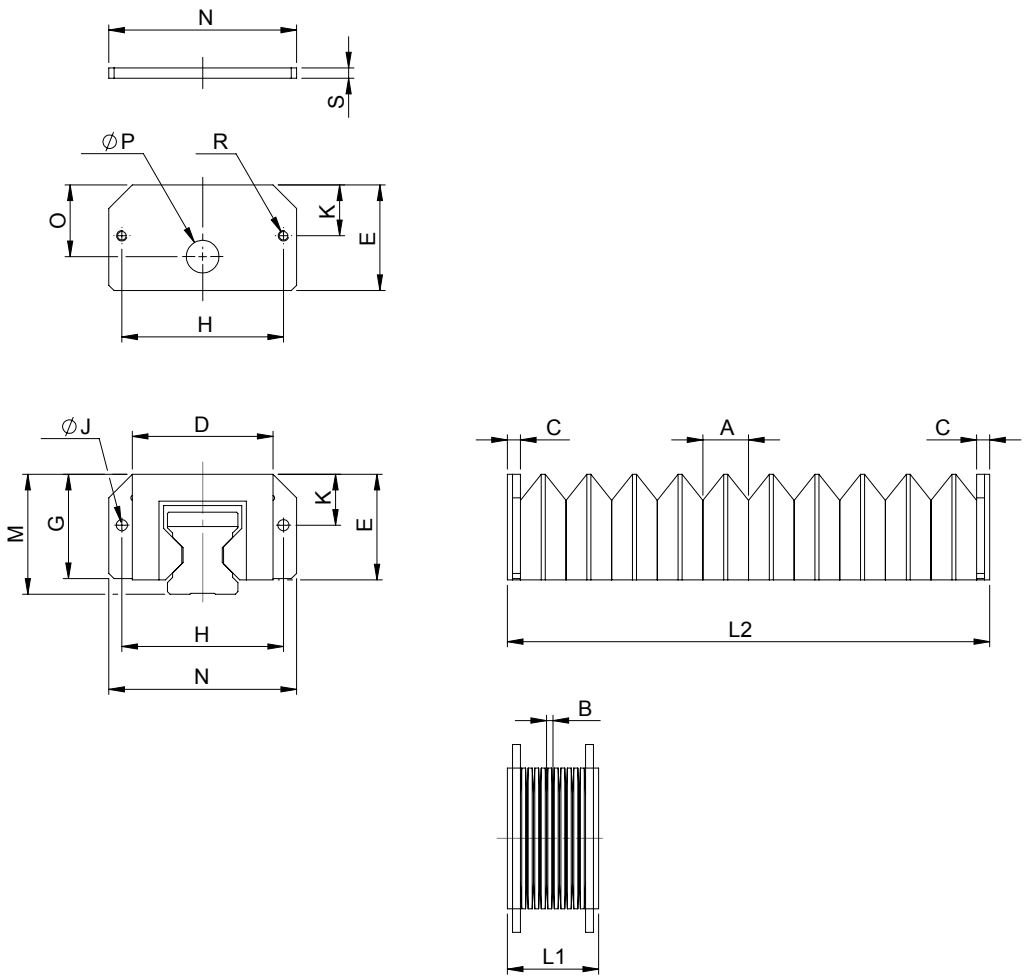



Check whether the operating conditions require a gear rack protection.
 This gear rack protection is **not suitable for use in welding areas**.
 It is shipped with two retaining plates and screws.

The gear rack protection is silicone-free.

Always add the number of folds "F = _ _ _" to the article number.

| lifgo® linear gear rack protection | | Unit | 5.0 | 5.1 | 5.3 |
|------------------------------------|---------|------|----------------------------------|----------------------|----------------------|
| Stroke per fold | A | mm | 17,5 | 17,5 | 27,5 |
| | B | mm | 2,5 | 2,5 | 2,5 |
| | (A – B) | mm | 15 | 15 | 25 |
| | C | mm | 5 | 5 | 5 |
| Number of folds | D | mm | 50 | 54 | 92 |
| | E | mm | 36,5 | 40,5 | 66,5 |
| | F | each | as per customer data | | |
| | G | mm | 36 | 40 | 66 |
| Stroke | H | mm | 58 | 62 | 100 |
| | J | mm | ∅ 4,3 √ 8,5 x 90° | ∅ 4,3 √ 8,5 x 90° | ∅ 4,3 √ 8,5 x 90° |
| | K | mm | 18,5 | 19,5 | 23,5 |
| | L | mm | $L = L2 - L1 = F \times (A - B)$ | | |
| | L1 | mm | $L1 = 2 \times C + F \times B$ | | |
| | L2 | mm | $L2 = 2 \times C + F \times A$ | | |
| | M | mm | 40 | 46 | 71,5 |
| | N | mm | 68 | 72 | 112 |
| | O | mm | 24 | 27,5 | 45 |
| | P | mm | ∅ 10,5 | ∅ 12,5 | ∅ 20,5 |
| R | mm | M4 | M4 | M4 | |
| S | mm | 4 | 4 | 4 | |

| Article number | 5.0 | 5.1 | 5.3 |
|------------------------------------|---------|---------|---------|
| lifgo® linear gear rack protection | 500 125 | 500 126 | 500 127 |
| lifgo® linear end plate | 500 540 | 500 542 | 500 544 |