

# Signal pillars

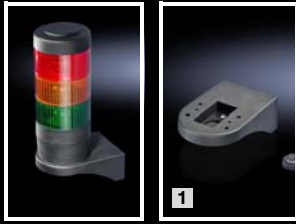

1



2



3

## Mounting components for wall/base mounting

Fig.	Mounting component	Colour	Suitable for signal pillar		Model No.
			LED compact	modular	
1	Bracket for wall mounting, including rubber gland for concealed cable routing	Black	■	–	2372.110
2	Bracket for connection component	Black	–	■ <sup>1)</sup>	2374.040
3	For side cable outlet	Black	–	■ <sup>1)</sup>	2374.080

### ! Also required:

- <sup>1)</sup> Connection component 2368.010, see page 717

Bracket for wall mounting

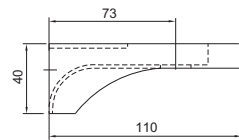

Bracket for connection component

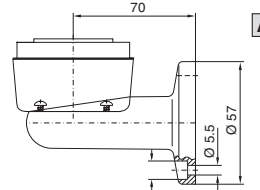

For side cable outlet

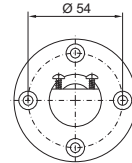
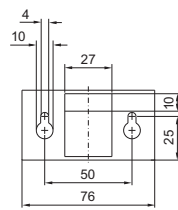
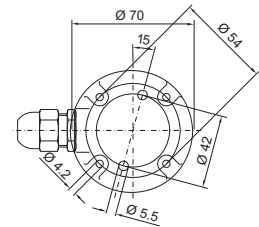

- A Seal
- B Flat seal

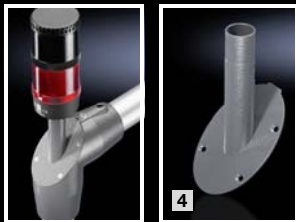
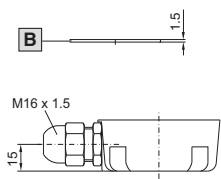

4



5



6

## Mounting components for support arm systems

For external mounting of a signal pillar on the plastic cover of the support arm components.

Fig.	Mounting component	Colour	Suitable for signal pillar		Model No.
			LED compact	modular	
4	for support arm system CP 40, steel – Angle piece 90° 6501.140	RAL 7024 (graphite grey)	■ <sup>1)</sup>	■ <sup>2)</sup>	2375.030
5	for support arm system CP 60 – Angle adaptor 90° for support arm combination CP 60 to CP 40 6206.640 – Angle coupling 90° 6206.380 – Angle piece 90° 6206.600 – Intermediate hinge 6206.620 – Wall-mounted hinge 6206.740 – Top-mounted joint 6206.700	RAL 7024 (graphite grey)	■ <sup>1)</sup>	■ <sup>2)</sup>	6206.900
6	for support arm system CP 120 – Angle coupling 90° 6212.380 – Angle piece 90° 6212.600 – Intermediate hinge 6212.620 – Wall-mounted hinge 6212.740 – Top-mounted joint 6212.700	RAL 7024 (graphite grey)	■ <sup>1)</sup>	■ <sup>2)</sup>	6212.900
	for support arm system CP 180 – Angle piece 90° 6218.600 – Top-mounted joint 6218.700	RAL 7024 (graphite grey)	■ <sup>1)</sup>	■ <sup>2)</sup>	6212.900

### ! Also required:

- <sup>1)</sup> Connection adaptor 2372.120, see page 716
- <sup>2)</sup> Connection component 2368.000, see page 717