

SERIES 64

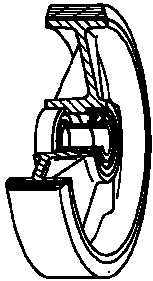

**“TR” POLYURETHANE WHEELS,
CAST IRON CENTRE,
FIXED PLATE BRACKET TYPE EE MHD**

Wheel description



Tread: “TR” polyurethane, hardness 95 +/- 3 Shore A.

Centre: cast iron.

Hub: the housing is obtained by moulding and turning and contains ball bearings series Z

Bracket description

EE Medium Heavy Duty bracket (max. load capacity 900 daN)

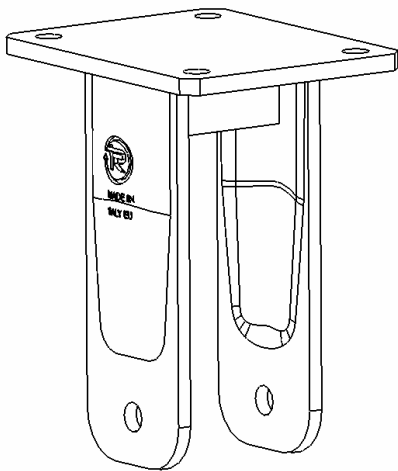

The bracket is made by a steel forged fixing plate with 4 holes, by two steel drawn sides and by a steel central stiffening. These elements are bounded by welding and properly protected against oxydation.