

SERIE 65ER

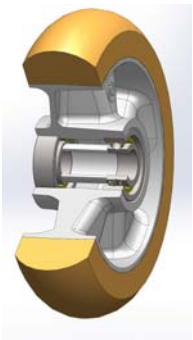

THICK “TR” POLYURETHANE WHEELS WITH ERGONOMIC ROUND PROFILE, ALUMINIUM CENTRE, FIXED BRACKET TYPE M

Wheel description



Tread: Thick TR polyurethane wheels with round ergonomic profile, hardness 95 Shore A.

Centre: cast aluminium

Hub: the housing is obtained by moulding and contains ball bearings series Z.

Bracket description

Fixed bracket type M (max. load capacity 500 daN)

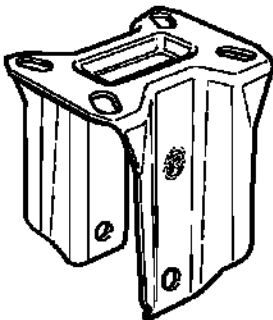

The bracket is made by an electrolytically galvanised steel fork.