

SERIES 64

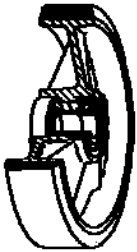

**“TR” POLYURETHANE WHEELS,
CAST IRON CENTRE,
FIXED BRACKET TYPE EP**

Wheel description



Tread: “TR” polyurethane, hardness 95 +/- 3 Shore A.

Centre: cast iron.

Hub: the housing is obtained by moulding and turning and contains ball bearings series Z

Bracket description

Extra-heavy duty bracket type EP (max. load capacity 1600 daN)

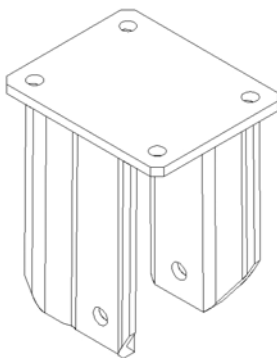

The bracket is made by a white galvanised steel fork.