

Universal Struts

Witte universal struts comprising of strut tips and tubes are easy and quick to assemble because of angle and strut lengths which are both variable.

The strut tips can also be used in any grid point of systems (Alufix Classic 25 / 40 / 50).

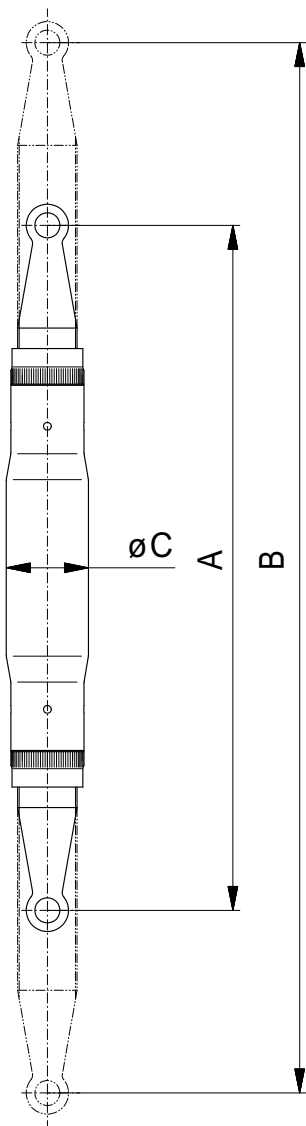

Universal struts

System Alufix 25

Nr.	System	C	A - B	g
84937	AF 25	36	460 - 600	256
84938	AF 25	36	620 - 840	1.320
84939	AF 25	36	870 - 1090	1.433
84940	AF 25	36	1120 - 1340	1.745
84941	AF 25	50	1378 - 1570	2.012
84942	AF 25	50	1628 - 1820	3.672
84943	AF 25	50	1878 - 2070	4.172
84944	AF 25	50	2128 - 2320	4.672
84945	AF 25	50	2378 - 2570	5.172
84946	AF 25	50	2628 - 2820	5.672

Universal struts

System Alufix 40

Nr.	System	C	A - B	g
84947	AF 40	36	460 - 600	1.042
84897	AF 40	36	620 - 840	1.123
84948	AF 40	36	870 - 1090	1.361
84949	AF 40	36	1120 - 1340	1.673
84804	AF 40	50	1378 - 1570	1.940
84806	AF 40	50	1628 - 1820	3.600
84807	AF 40	50	1878 - 2070	4.100
84893	AF 40	50	2128 - 2320	4.600
84894	AF 40	50	2378 - 2570	5.200
84895	AF 40	50	2628 - 2820	5.800

Universal struts

System Alufix 50

Nr.	System	C	A - B	g
84950	AF 50	36	460 - 600	1.036
84951	AF 50	36	620 - 840	1.117
84952	AF 50	36	870 - 1090	1.355
84953	AF 50	36	1120 - 1340	1.667
84954	AF 50	50	1378 - 1570	1.934
84955	AF 50	50	1628 - 1820	3.594
84956	AF 50	50	1878 - 2070	4.094
84957	AF 50	50	2128 - 2320	4.594
84958	AF 50	50	2378 - 2570	5.194
84959	AF 50	50	2628 - 2820	5.794



ALUFIX CLASSIC elements can be anodized in different colours. The colour natural is standard, black (-1) is available as an alternative. Other colours on request.

Other versions on request