

## Screw-jack

with precision thread and check nut

Nr.	A/min	A/max	B	C	D	E	
90614	38	50	8	32	M4	24x1	65
82139	38	50	12,5	32	M6	24x1	65
82033	70	105	12,5	32	M6	24x1	120
82085	110	170	20	42	M10	32x1	330

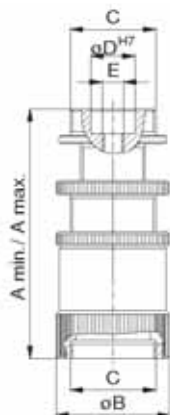

## Screw-jack with anti-turn lock

D32 and D42

Nr.	A min.	A max.	B	C	D	E	
285201	50	70	32	M24x1	12,5	M6	78
285202	70	105	32	M24x1	12,5	M6	120
285203	105	170	42	M32x1	20	M10	310

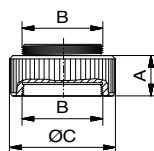
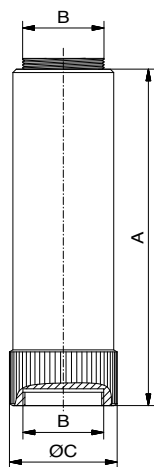

## Screw-jack extension

Nr.	A	B	C	
20628	6	M24x1	32	12
23286	12	M24x1	32	25
22856	100	M24x1	32	210
21658	100	M32x1	42	225